

BLU  
DOT

# PEGGY

ASSEMBLY NOTES

LOOK AT THE VIEW

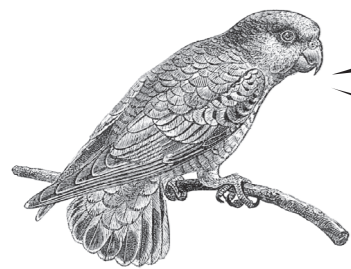
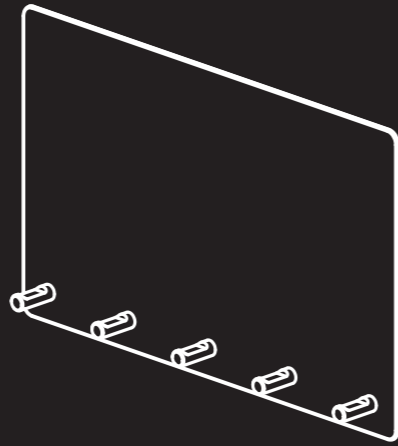

## CARE

Clean wood with a slightly damp, soft cloth. To remove dirt and fingerprints, use a quality cleaner formulated for wood furniture. Wipe completely dry with a soft cloth in the direction of the wood grain.

## PARTS & HARDWARE

x5  
1066

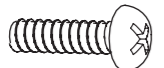

MIRROR

x1

x5

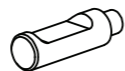

PEG

x1

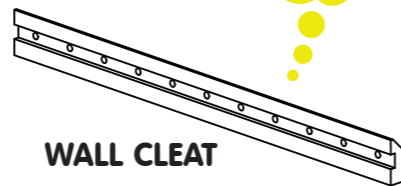

WALL CLEAT

1

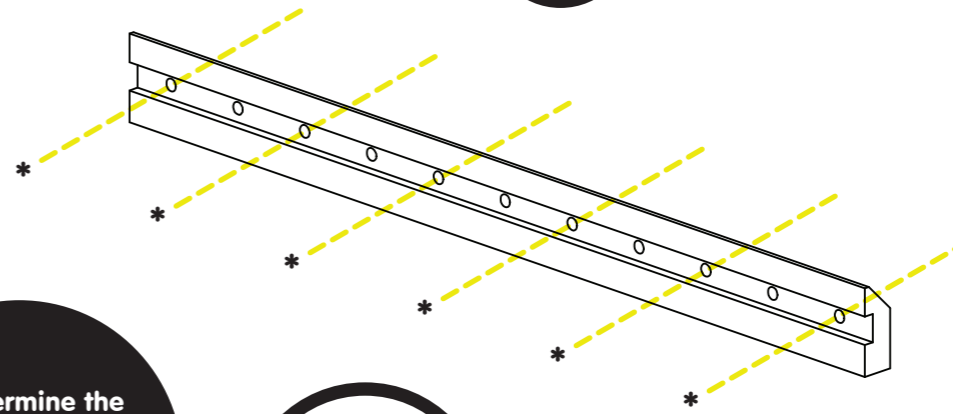

SIDE VIEW

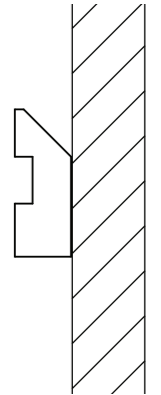

To determine the hardware best suited for your type of wall, consult your local hardware professional.

Make sure wall cleat is horizontal with a wall level.

2

Attach pegs to mirror with provided screws, do not over tighten. Re-tighten as needed. Set mirror on wall cleat as shown.

SIDE VIEW

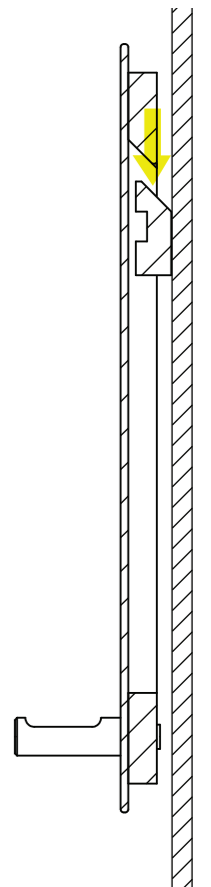

NOTE: Insert pegs from the front and tighten from the rear. Never tighten by turning peg. Doing so may result in cracking.

x5