

# Beau Table Lamp

DESIGNED IN 2017

ASSEMBLY NOTES | REV 00

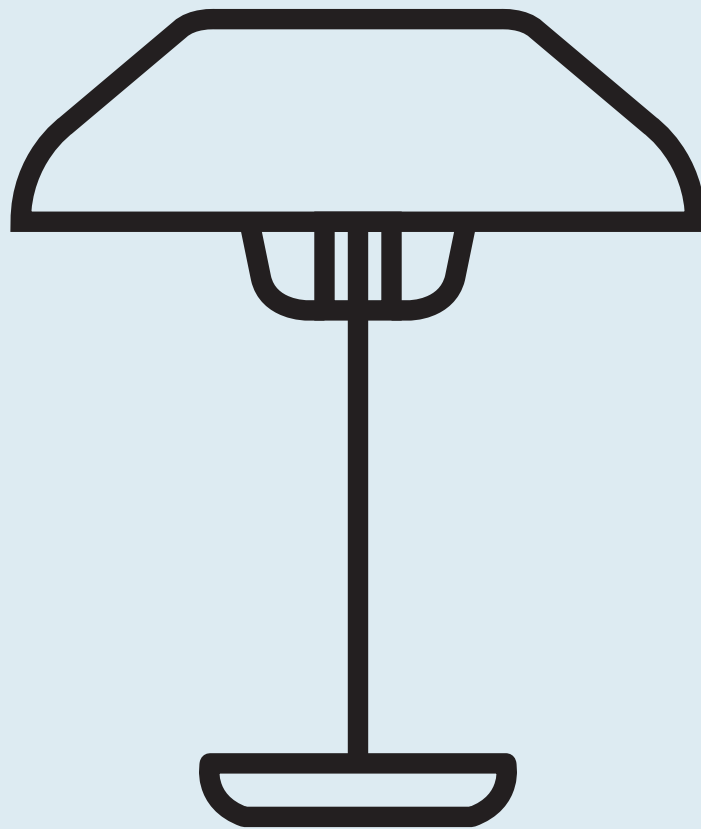

## GIVES GOOD SHADE.

A genteel steel shade and stalk rise from a rounded marble base. Turn on and off with the touch of a hand. With three levels of brightness to set the mood.

## NEED A HAND?

Contact us at [service@bludot.com](mailto:service@bludot.com) or **844.425.8368** for assistance.

# Parts & Hardware

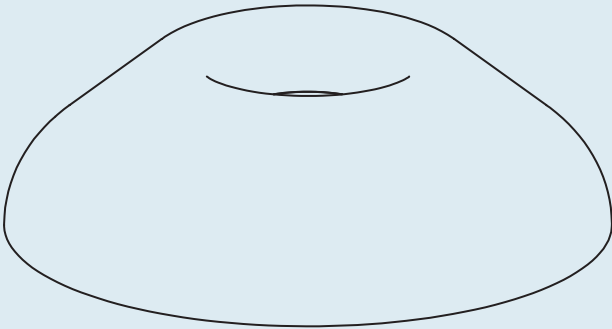

QTY \_\_\_\_\_ 1

Shade

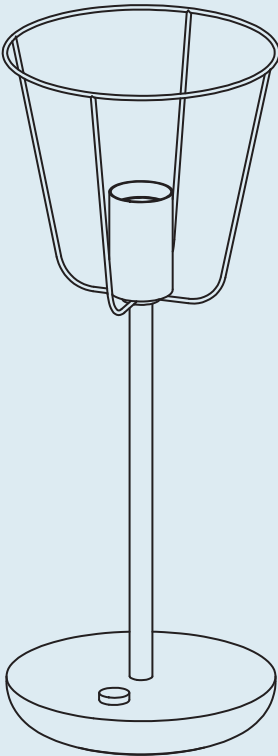

QTY \_\_\_\_\_ 1

Base

# Step 01

## INSTALL SHADE.

Place shade on metal ring for installation.

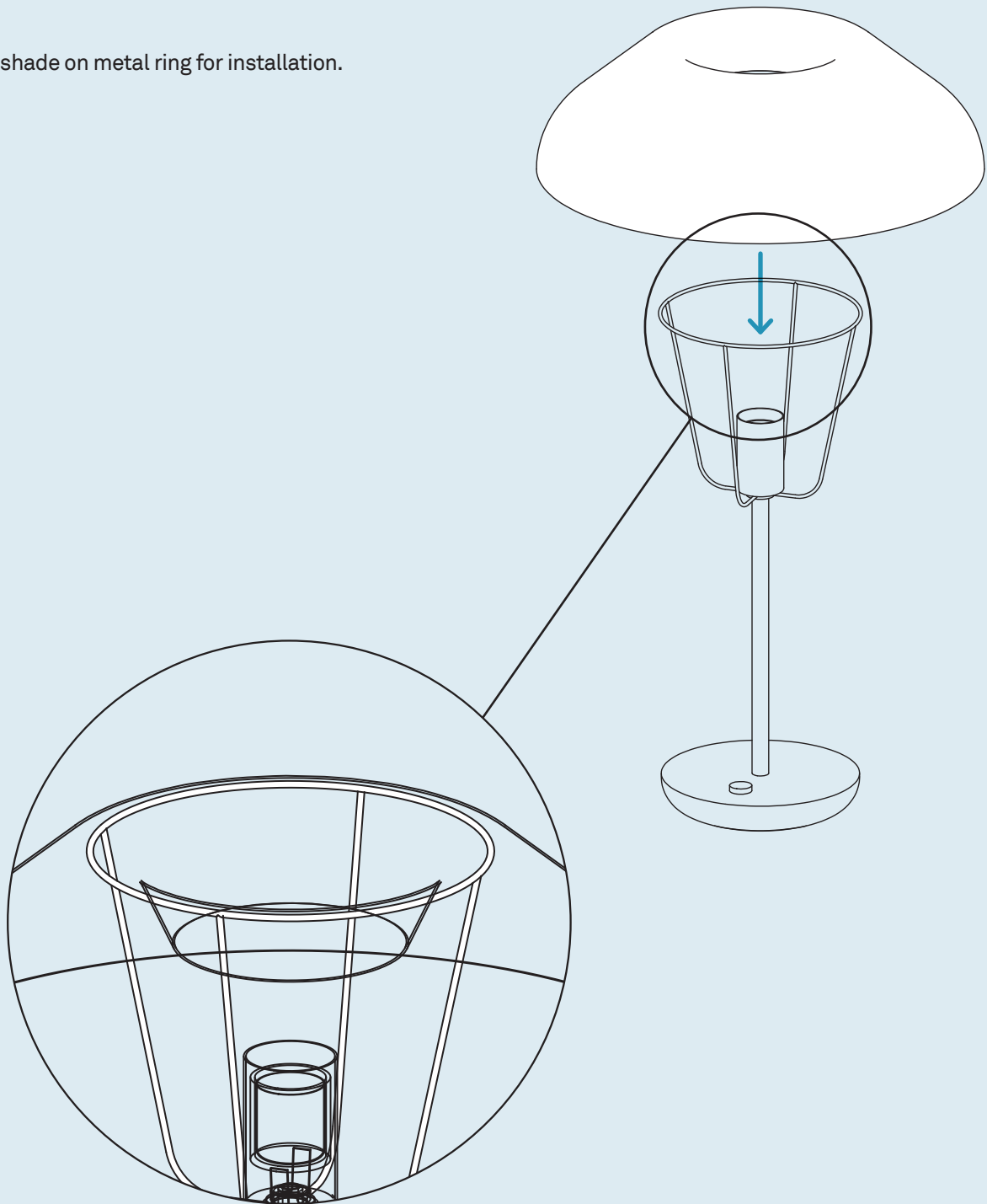

We recommend using a 60W G25 globe bulb.

## Additional Information

### NOTE

A light bulb is provided. We recommend using a 60W G25 globe bulb.

### CLEAN

Unplug lamp prior to cleaning. Clean with a slightly damp, soft cloth. To remove dirt and fingerprints, use a quality cleaner formulated for painted metal surfaces. Do not use abrasive cleaners.

