

Apt Table Collection

DESIGNED IN 2019

ASSEMBLY NOTES | REV 01

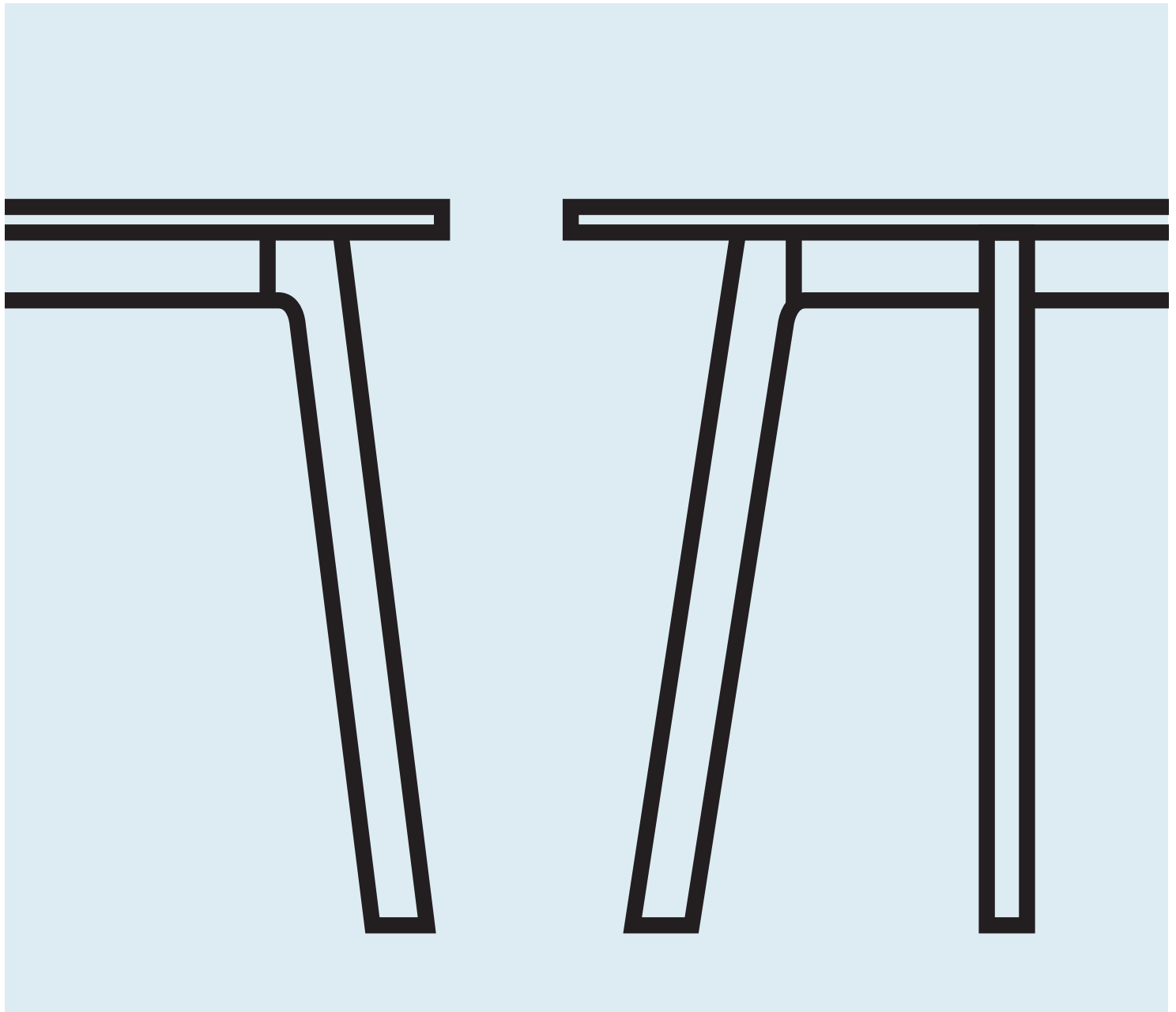
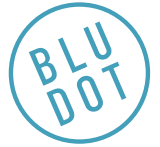

NEED A HAND?

Contact us at service@bludot.com or
844.425.8368 for assistance.

@BLUDOT

We design all our pieces in our Minneapolis studio. Follow
along on Instagram for some sneak peeks into the process.

Parts & Hardware



QTY 8*

Pt. 1105

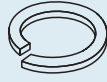

QTY 8*

Pt. 3005

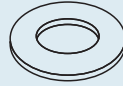

QTY 8*

Pt. 3007

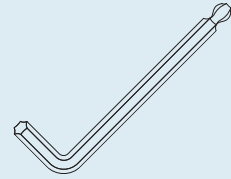

QTY 1

Pt. 9018

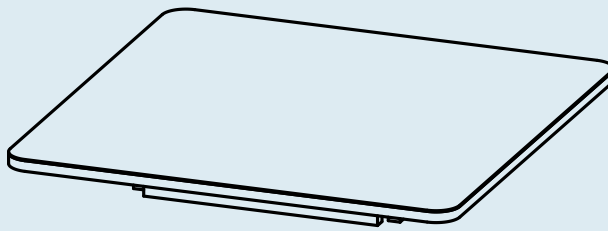

QTY 1

Top Frame



QTY 4*

Leg

*Round Cafe and Side tables ship with x3 legs and x6 attachment hardware.

Step 01

ATTACHING THE LEGS.

Place the top frame face down on a soft surface as shown. Align the leg with the table apron as shown and attach using the provided hardware. Repeat for the remaining legs.

Have a second person help lift and rotate the table before placing down on the table legs.

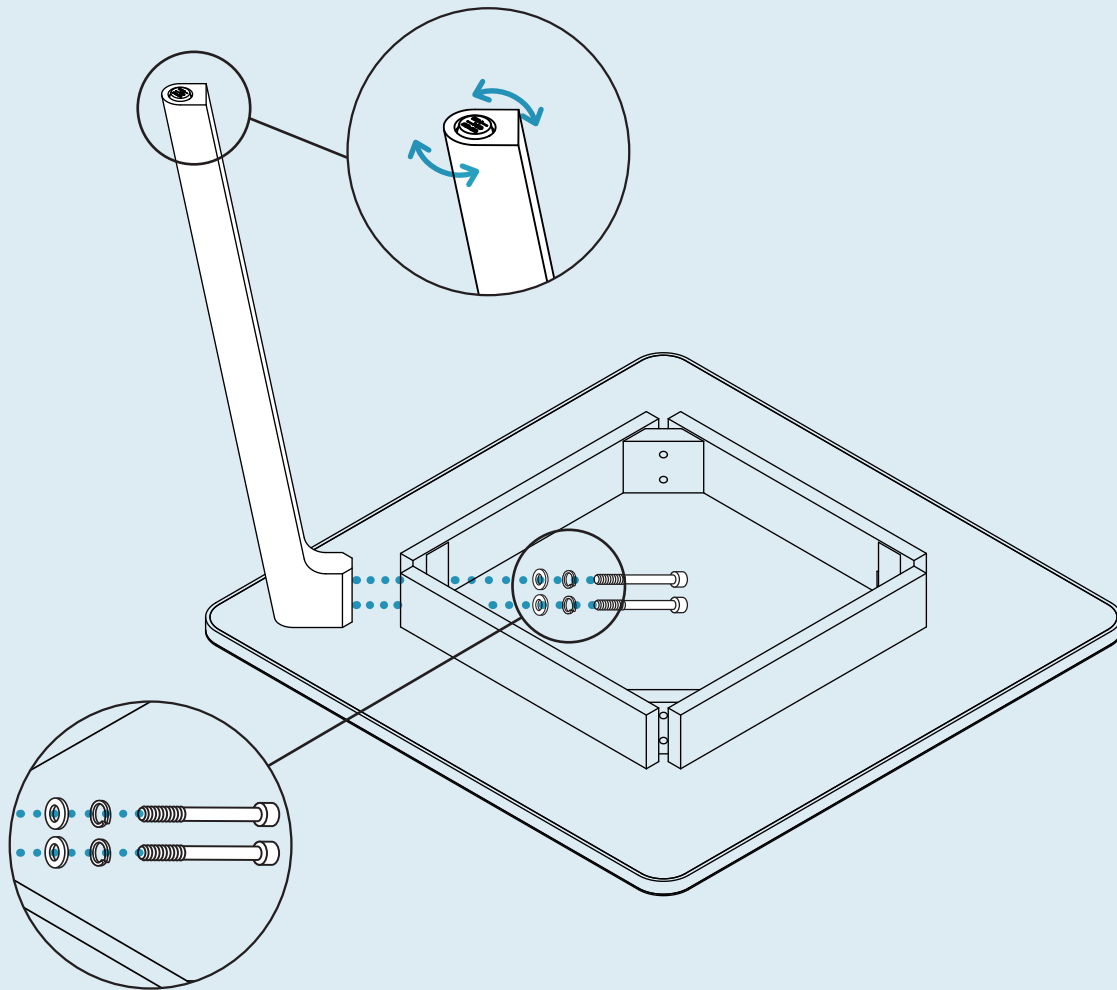

PT. 1105 x 8*



PT. 3005 x 8*



PT. 3007 x 8*

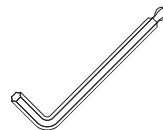

PT. 9018 x 1

Additional Information

CLEAN

Clean with a slightly damp, soft cloth. To remove dirt and fingerprints, use a quality cleaner formulated for wood furniture. Wipe completely dry with a soft cloth in the direction of the wood grain.

