

Amos Coat Rack

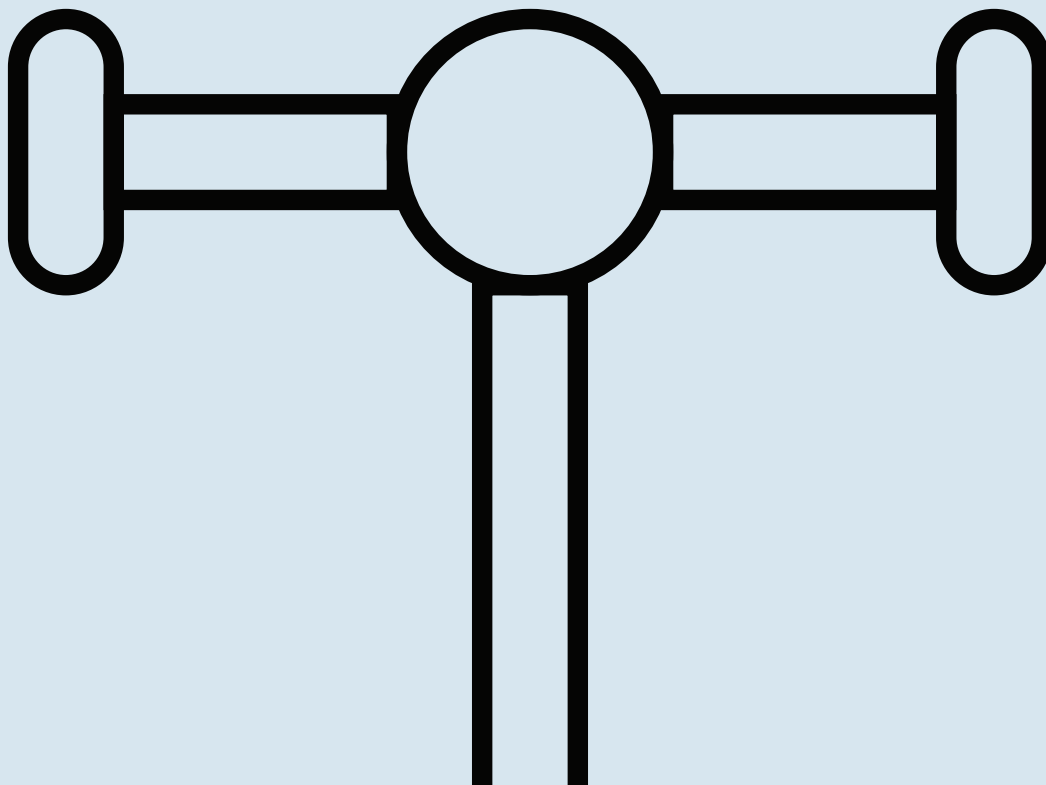

DESIGNED IN 2016

ASSEMBLY NOTES | REV 00



SUPPORT SYSTEM.

A compact solution to sorting the baggage of daily life. Hang stuff north, south, east, west - Amos keeps all that business in check.

NEED A HAND?

Contact us at service@bludot.com or **844.425.8368** for assistance.

Parts & Hardware

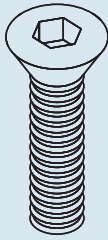

QTY 1

Pt. 1090

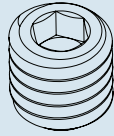

QTY 1

Pt. 1091

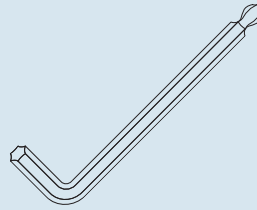

QTY 1

Pt. 9018

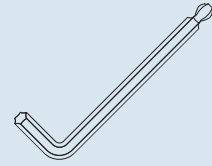

QTY 1

Pt. 9023

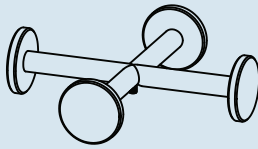

QTY 1

Coat Hook

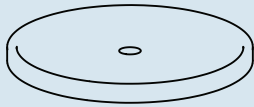

QTY 1

Wood Disk

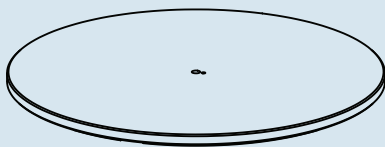

QTY 1

Metal Base



QTY 1

Upper Tube



QTY 1

Lower Tube

Step 01

ATTACH BASE.

Align metal pin on lower tube with metal base.
Attach base to lower tube using the provided hardware as shown.

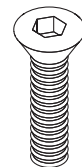
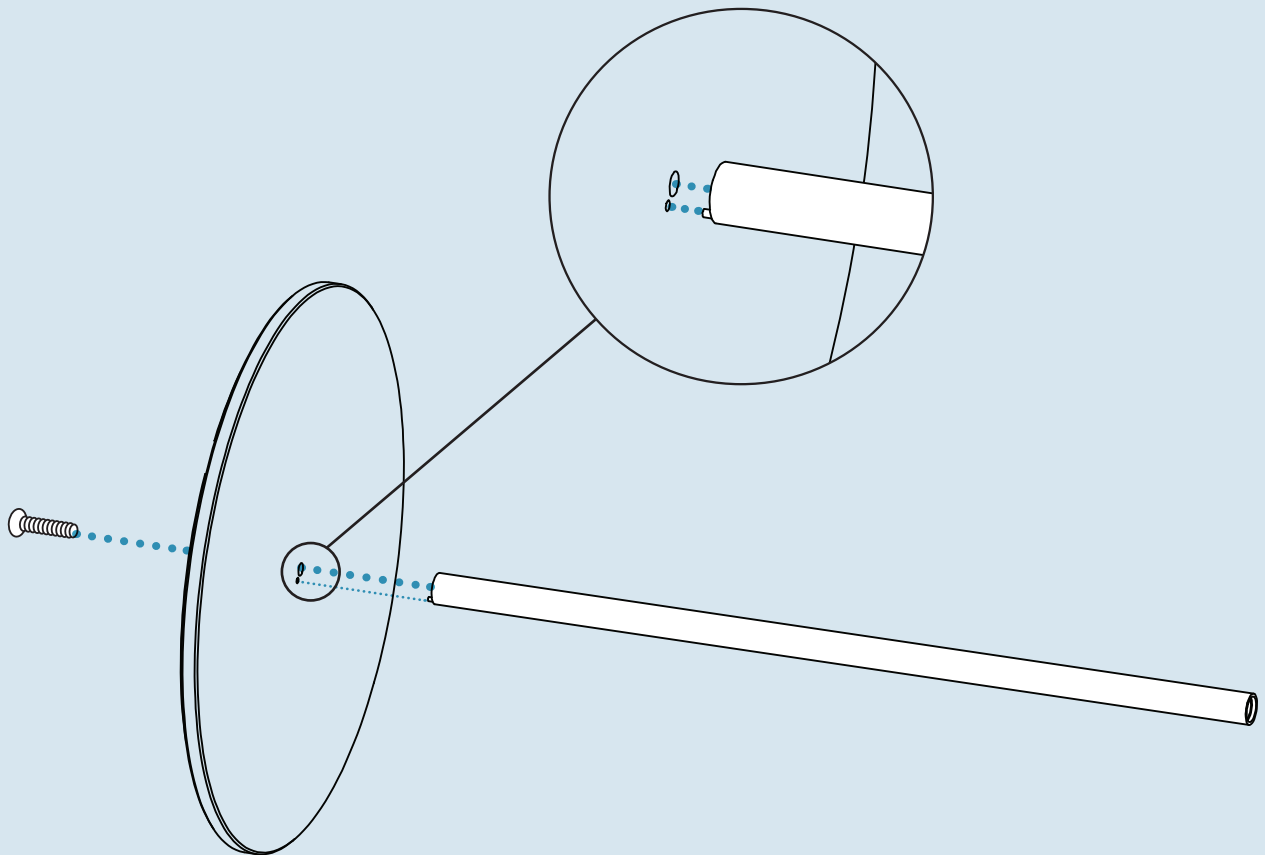

PT. 1090 x 1

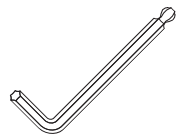

PT. 9018 x 1

Step 02

ATTACH WOOD DISK.

Place wood disk on lower tube. Align upper tube with lower tube and screw into place.

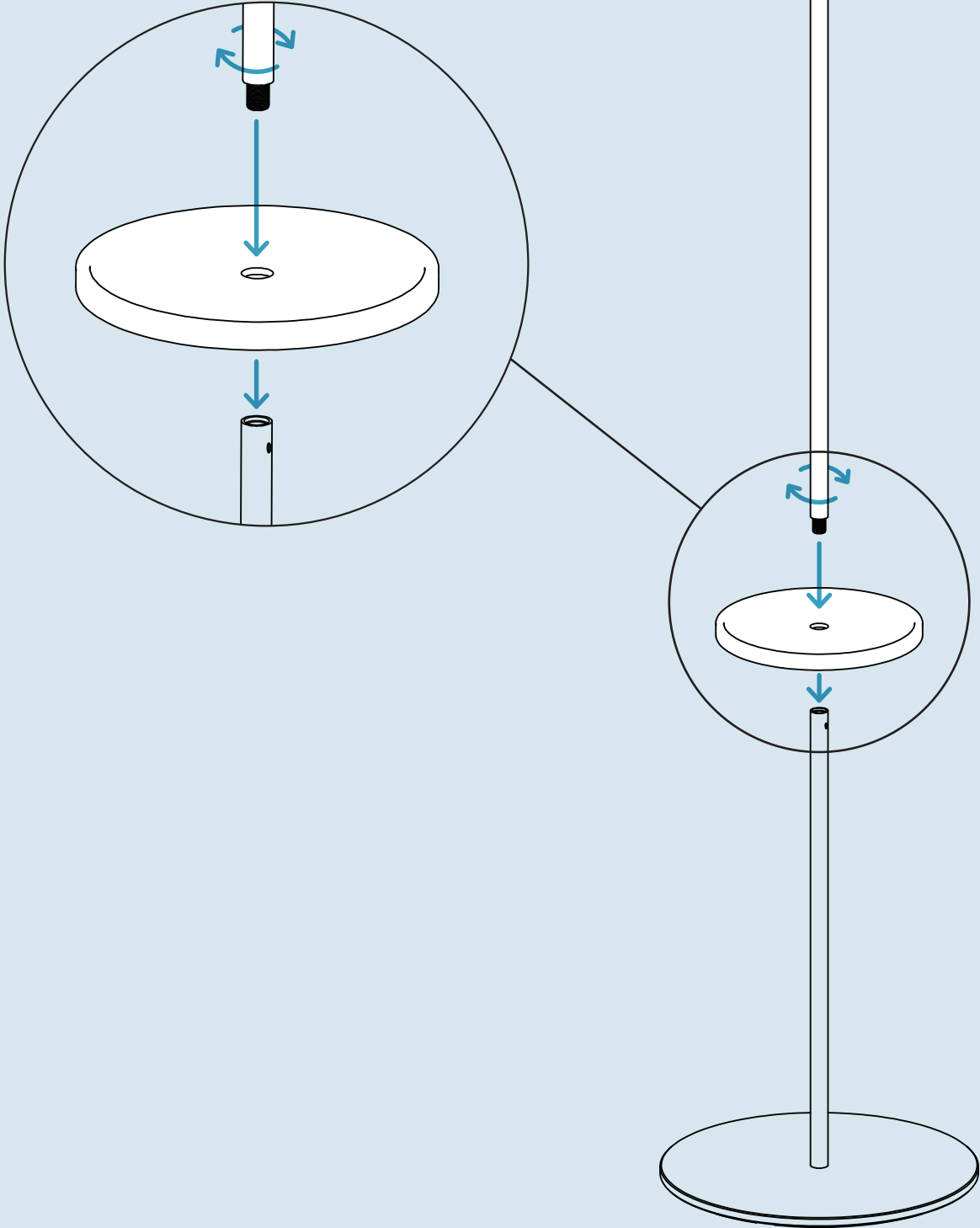

Step 03

INSTALL SET SCREW.

Locate threaded hole in upper portion of lower tube. Install provided set screw here, ensure tightness before moving on to step 04.

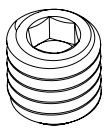
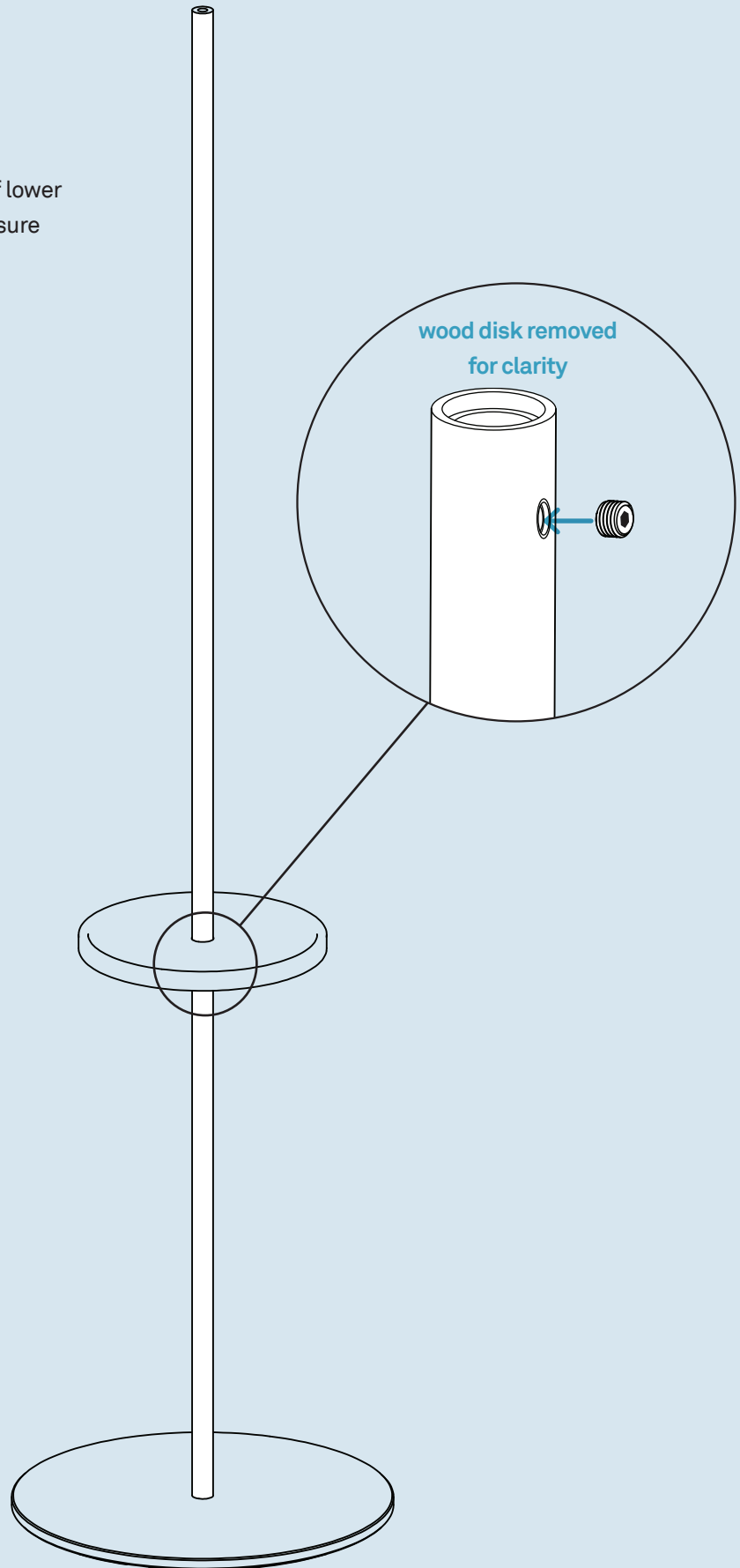

PT. 1091 x 1

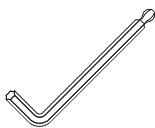

PT. 9023 x 1

Step 04

ATTACH COAT HOOKS.

Align coat hook assembly with upper tube and screw into place.

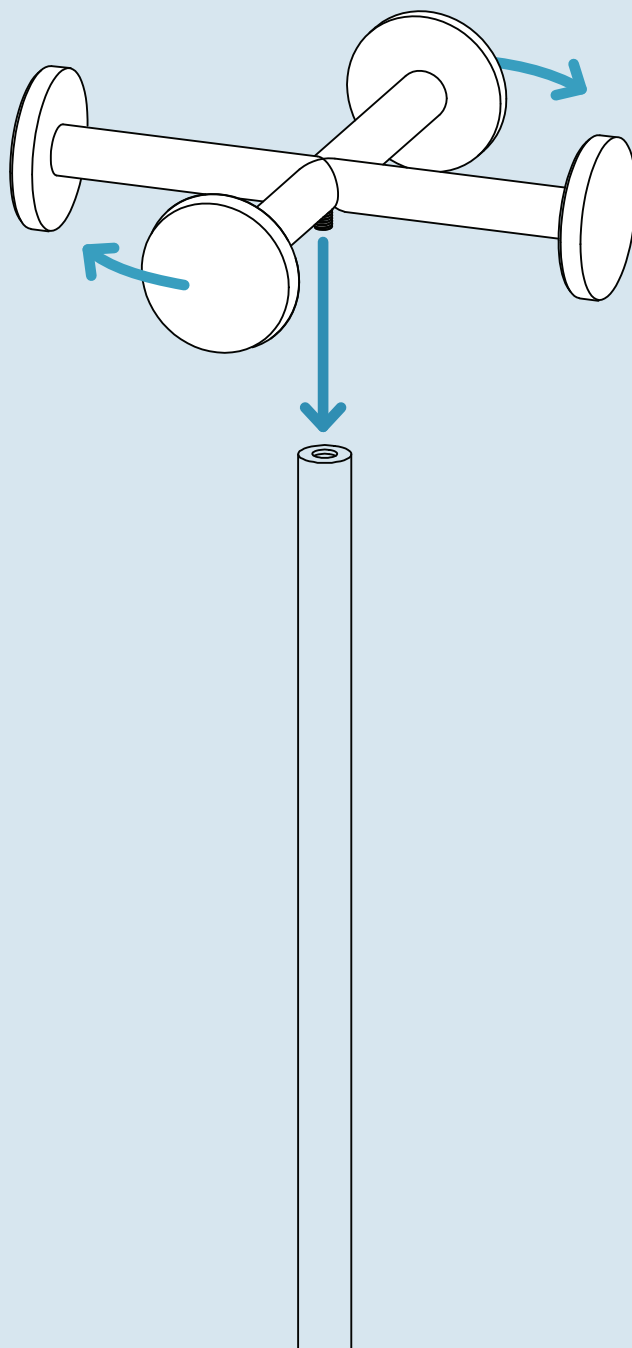

Additional Information

CLEAN

Clean with a slightly damp, soft cloth. To remove dirt and fingerprints, use a quality cleaner formulate for wood furniture. Wipe completely dry with a soft cloth in the direction of the wood grain.

