

BLU
DOT

2d3d WALL MAGAZINE RACK

ASSEMBLY NOTES

FROM FLAT
TO FABULOUS
IN NO TIME

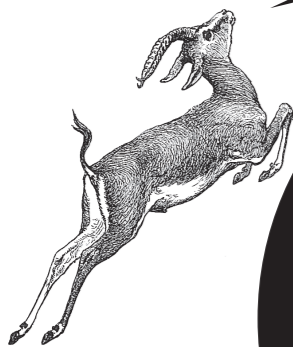

CARE

Clean with a soft cloth or sponge using a mild detergent, such as dish soap, and warm water. Wipe completely dry with a soft cloth.

1

Assemble on carpet or protective mat

NOTE: Save carton for step 11

Bend up 90 degrees.

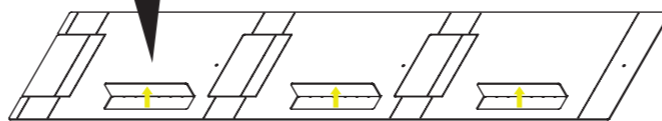
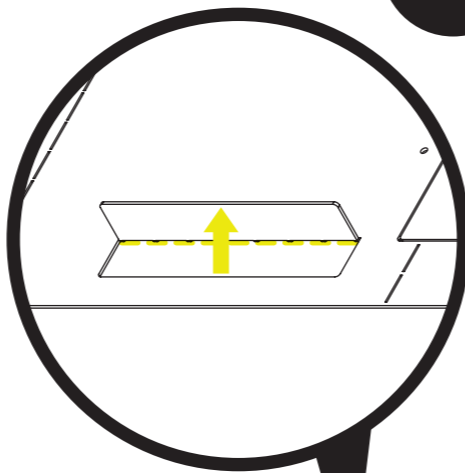

side view

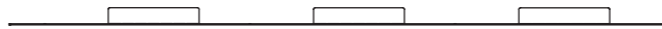

2

Bend up 90 degrees.

Keep flat.

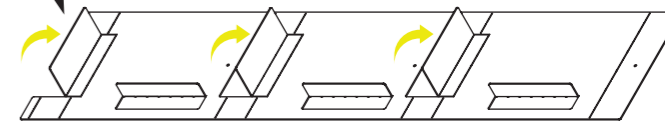
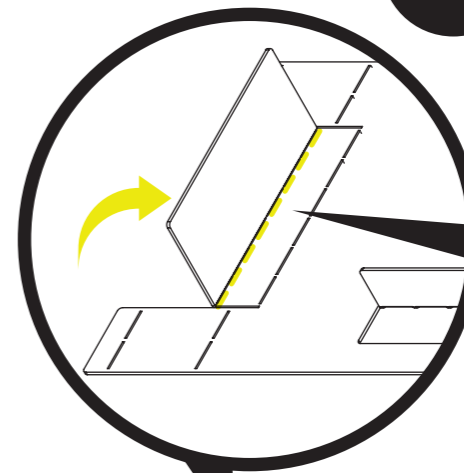

side view



3

Bend up 90 degrees.

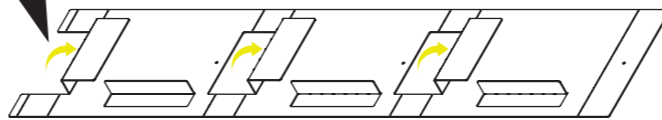
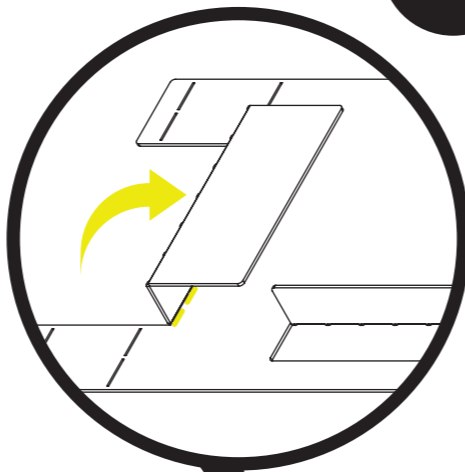

side view

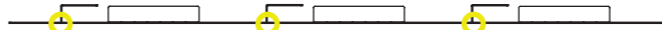

4

Bend up 90 degrees.

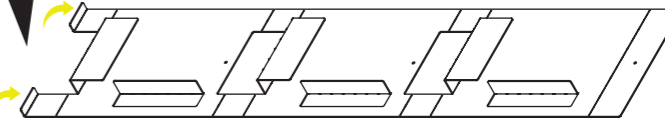
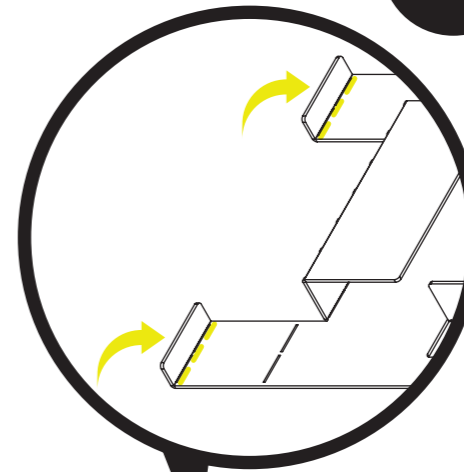

side view



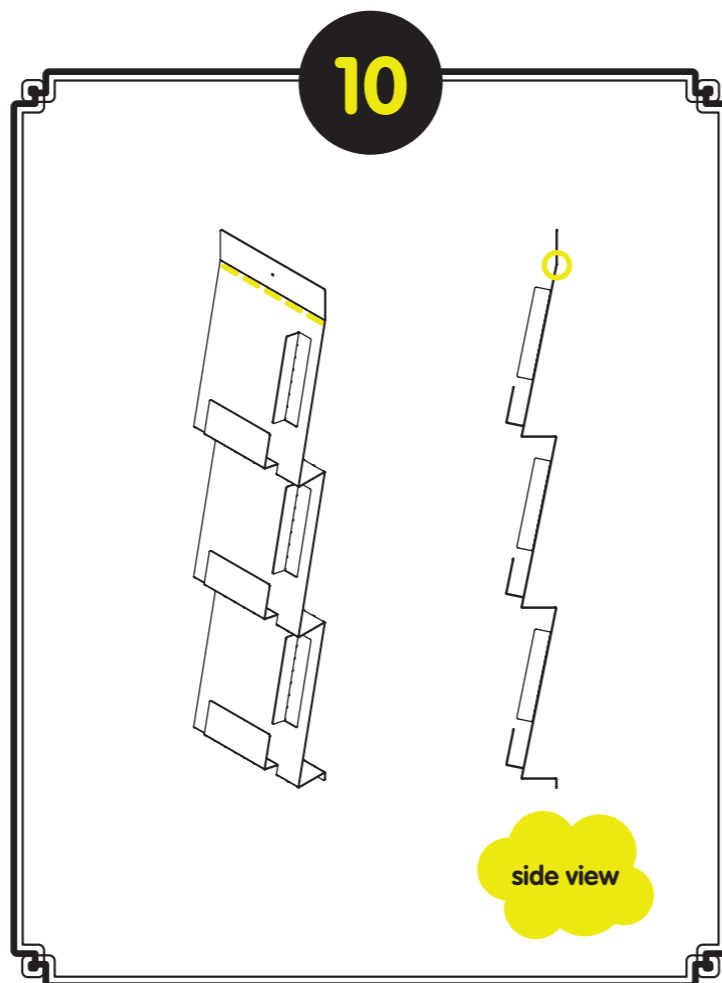
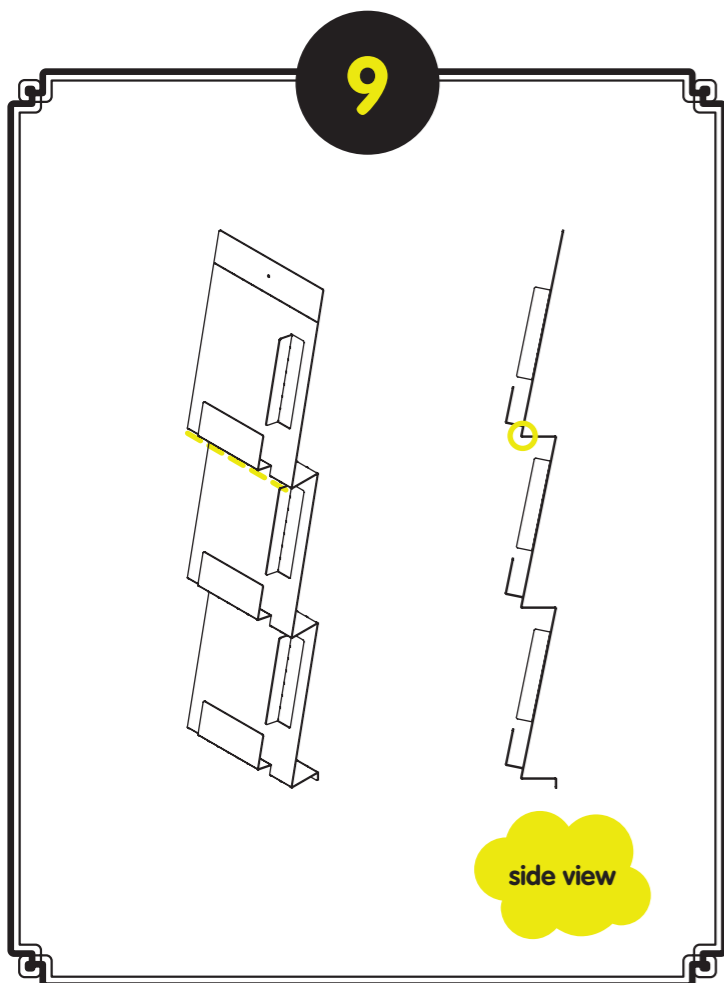
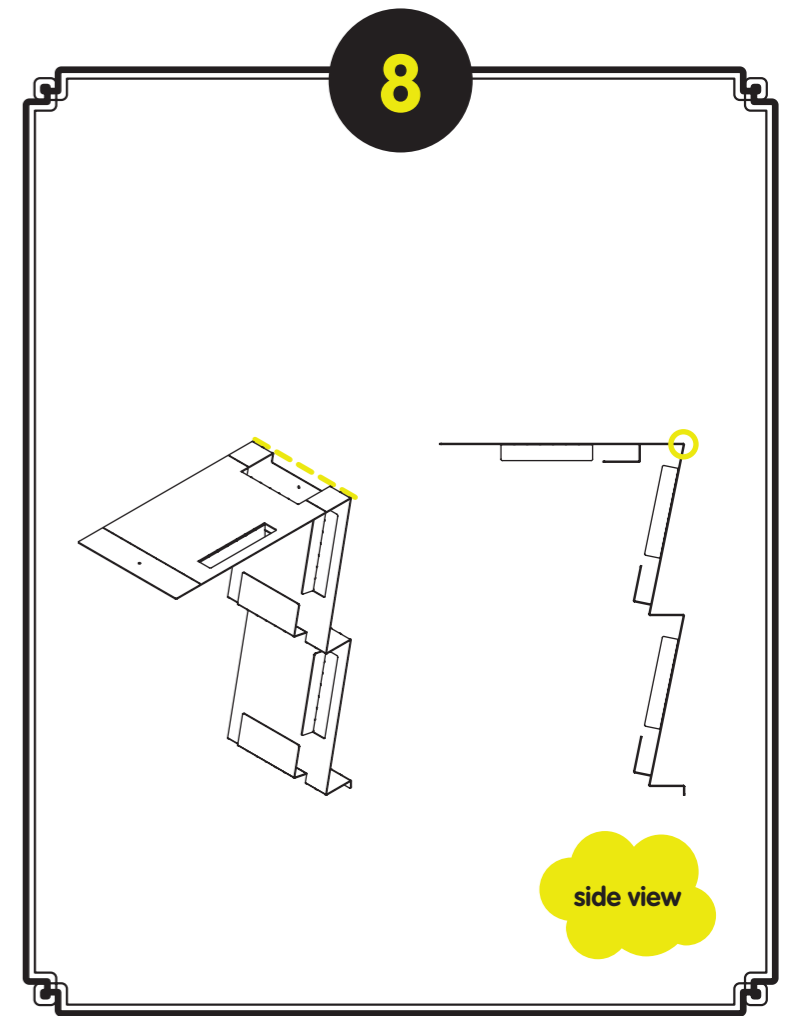
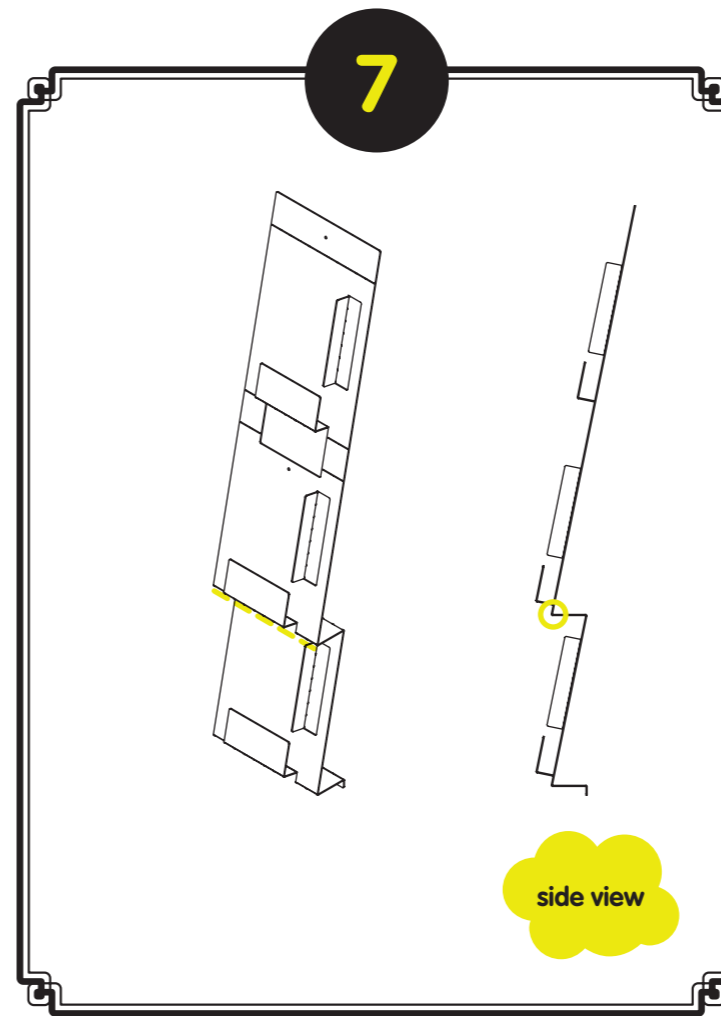
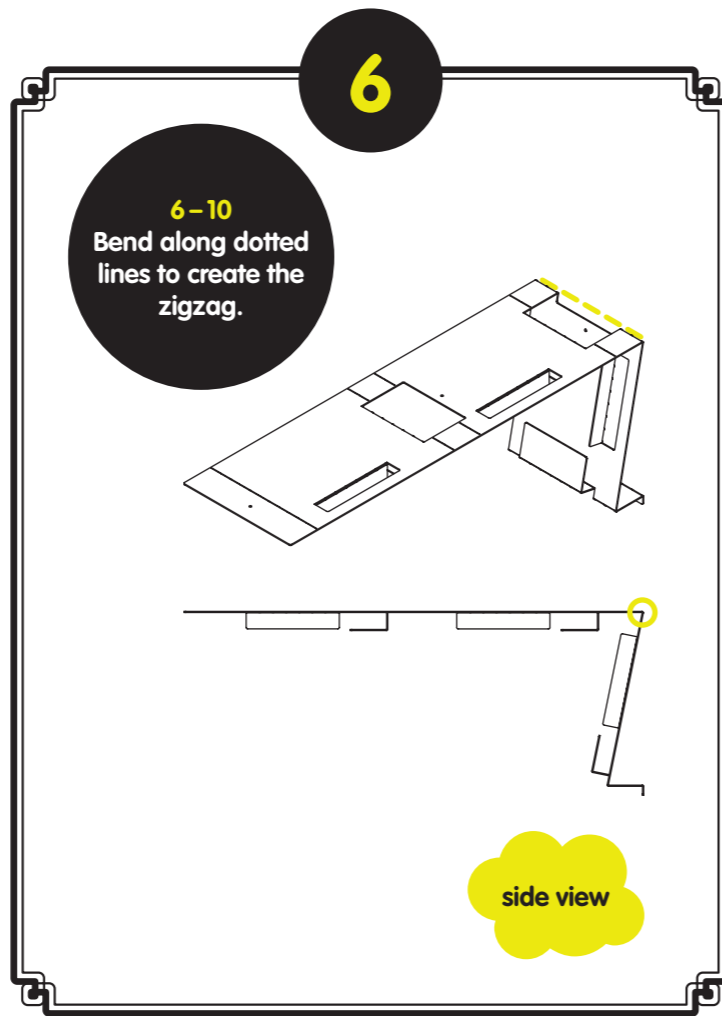
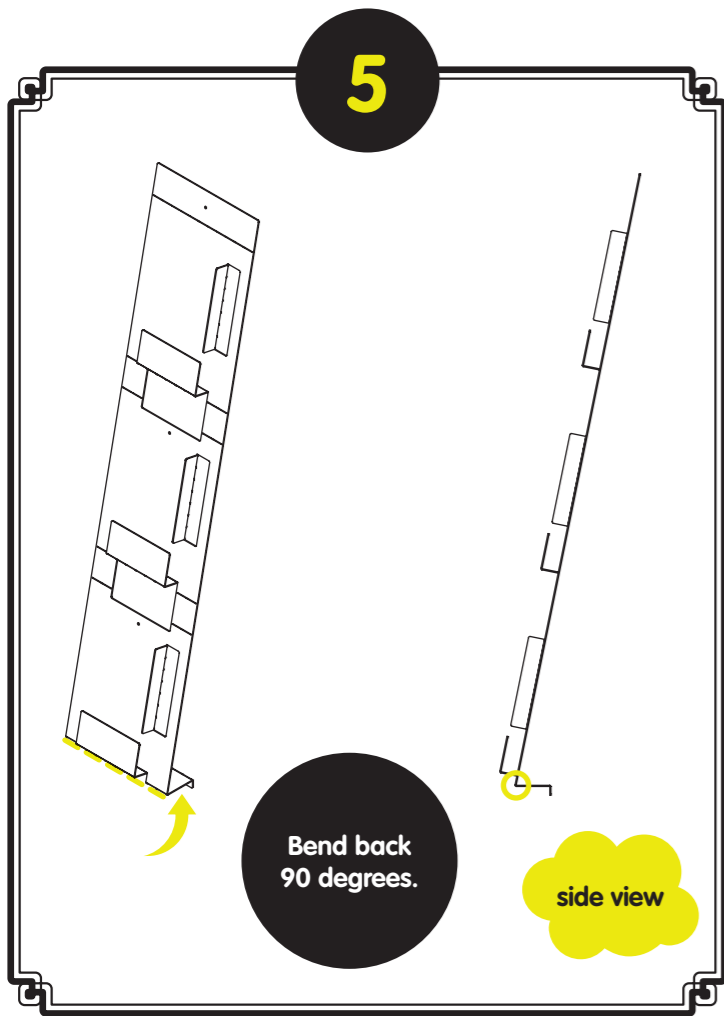

MOUNTING YOUR MAGAZINE RACK TO THE WALL

- 1) Position the magazine rack where you'd like it to be and mark the top screw hole with a pencil.
- 2) Drill a 3/16" hole and insert the blue plastic anchor until it is flush with the wall.
- 3) The cardboard carton has three holes to be used a hole template. Line up the top hole in the cardboard with the blue anchor screw. With the cardboard hanging on the screw, stand back and adjust the cardboard until it is level (like hanging a picture). Once level, mark the other two holes with a pencil.
- 4) Remove cardboard.
- 5) Drill remaining two 3/16" holes, and tap blue anchors into place.
- 6) Place your magazine rack over corresponding screw holes and insert screws. Tighten screws until snug.

NOTE: Tighten middle and lower screws until screw head is snug to metal surface. Over tightening these screws causes the piece to bend towards the wall.

